

SMALL MACHINE ROOM PASSENGER ELEVATOR CONSTRUCTION PARAMETER

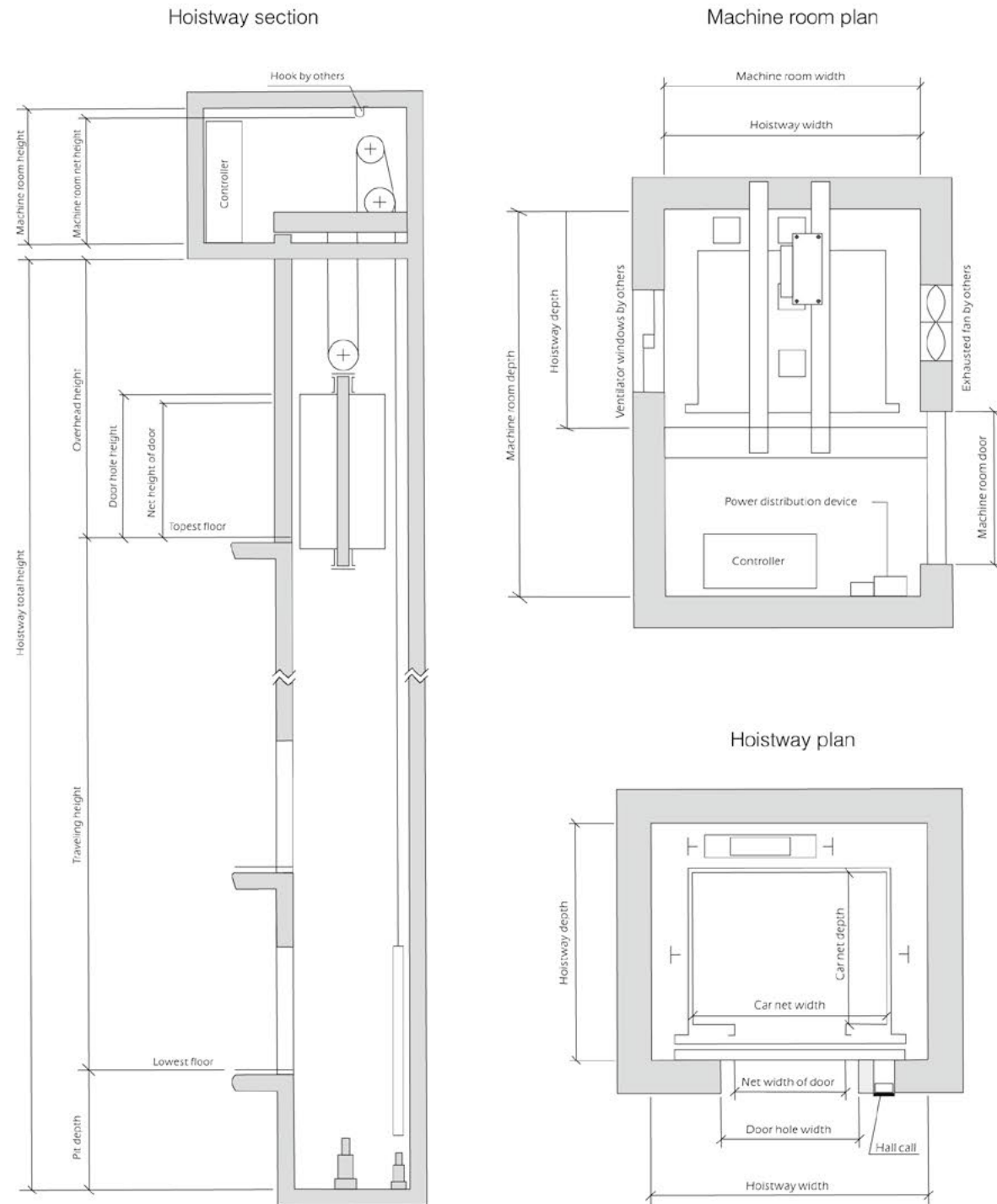

Persons	Rated capacity (kg)	Rated speed (m/s)	Car size (mm)	Door opening size JJ x HH	Hoistway net size			Machine room net size	
			AA x BB	Central opening	AH x BH	OH	PP	AM x BM	HM
5	400	1.0	1100 x 1000	700 x 2100	1700 x 1650	4500	1500	1700 x 1650	2900
8	630	1.0	1400 x 1100	800 x 2100	2000 x 1750	4500	1500	2000 x 1750	2900
		1.5/1.6/1.75				4600	1700		
10	800	1.0	1400 x 1350	800 x 2100	2000 x 2000	4500	1500	2000 x 2000	2900
		1.5/1.6/1.75				4600	1700		
		2.0				4900	1800		
		2.5				5100	2000		
		4.0				6350	3850		
13	1000	1.0	1600 x 1500	900 x 2100	2200 x 2150	4500	1500	2200 x 2150	2900
		1.5/1.6/1.75				4600	1700		
		2.0				4900	1800		
		2.5				5100	2000		
		3.0				5600	2600		
		3.5				5950	3100		
		4.0				6350	3850		
15	1150	1.0	1700 x 1500	1000 x 2100	2300 x 2150	4500	1500	2300 x 2150	2900
		1.5/1.6/1.75				4600	1700		
		2.0				4900	1800		
		2.5				5100	2000		
		3.0				5600	2600		
		3.5				5950	3100		
		4.0				6350	3850		
16	1250	1.0	1950 x 1400	1100 x 2100	2600 x 2100	4500	1500	2600 x 2100	2900
		1.5/1.6/1.75				4600	1700		
		2.0				4900	1800		
		2.5				5100	2000		
		3.0				5600	2600		
		3.5				5950	3100		
		4.0				6350	3850		
18	1350	1.0	1950 x 1550	1100 x 2100	2600 x 2200	4500	1500	2600 x 2200	2900
		1.5/1.6/1.75				4600	1700		
		2.0				4900	1800		
		2.5				5100	2000		
		3.0				5600	2600		
		3.5				5950	3100		
		4.0				6350	3850		
21	1600	1.0	1950 x 1750	1100 x 2100	2600 x 2450	4500	1500	2600 x 2450	2900
		1.5/1.6/1.75				4600	1700		
		2.0				4900	1800		
		2.5				5100	2000		
		3.0				5600	2600		
		4.0				6350	3850		
26	2000	1.0	2000 x 2100	1200 x 2100	3000 x 2600	4500	1500	3000 x 2600	2900
		1.5				4600	1700		
		1.75				4900	1800		
		2.0				5100	2000		